

REV	DESCRIPTION	DATE	ECN NO.	CHANGER
A/5	Add New Spec	012.01.05	2012003	Jock
A-6	Add New Spec	15.09.18		GB.Zeng

附表1

成品料号	规格	半成品料号	1	2	规格	前壳料号	3	规格	后壳料号	4	规格
USB-A1S162M-XL9X-W	USB3.0 Standard-A公焊线式成品	USB-A1S51M-XX9-X	USB A公9P 3.0 Standard/半成品	S-UMTX99	USB-A公 3.0 Standard/前壳	LOGO	CZT 3.0	USB-A公 3.0 Standard/后壳	S-UMXX100	USB-A公 3.0 Standard/后壳	
USB-A1S169M-XL9X-W	USB3.0 Standard-A公焊线式成品	USB-A1S55M-XX9-X	USB A公9P 3.0 Standard/半成品	S-UMTX113	USB-A公 3.0 Standard/前壳	NO	S-UMXX100	USB-A公 3.0 Standard/后壳	S-UMXX100	USB-A公 3.0 Standard/后壳	
USB-A1S216M-XL9X-W	USB3.0 Standard-A公焊线式成品(前壳镀金)	USB-A1S55M-XX9-X	USB A公9P 3.0 Standard/半成品	S-UMTG196	USB-A公 3.0 Standard/前壳(镀金2U*)	NO	S-UMXX100	USB-A公 3.0 Standard/后壳	S-UMXX100	USB-A公 3.0 Standard/后壳	
10310209F029	USB3.0 A公焊线式成品(IP~4P电流过3A)	29103C00972	半壳壳模30u/壳LOGO/PBT蓝色无齿	S-UMTN113	SPCC/镀锌	NO	S-UMTN100	SPCC/镀锌			

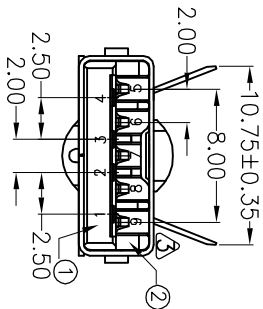
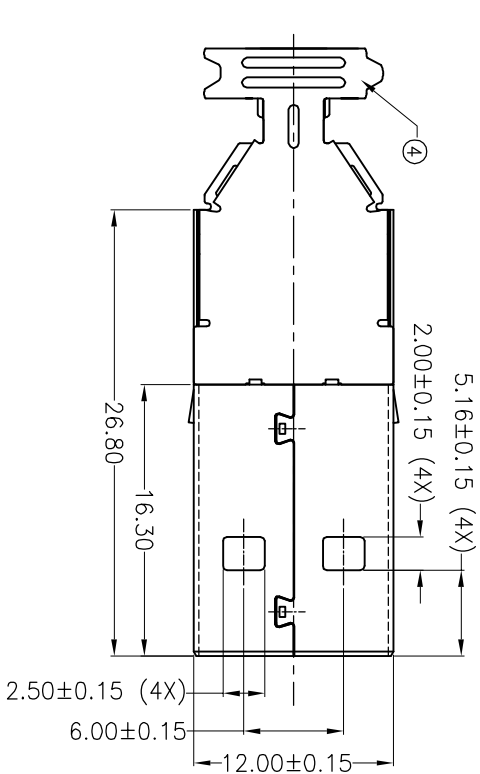
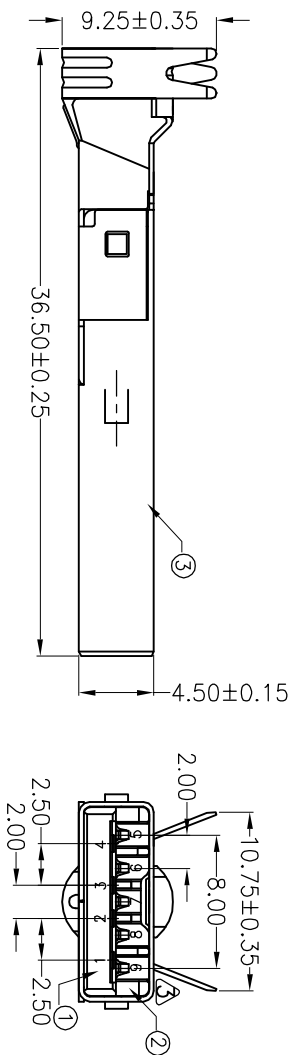
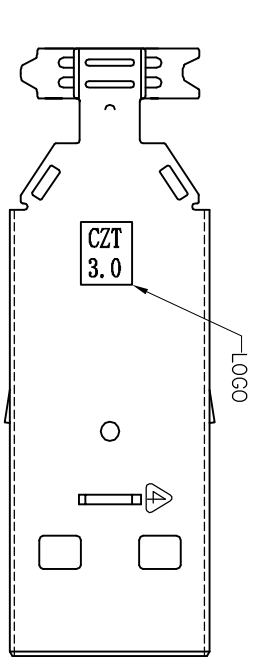

Specification

- Current Rating: 1.8 Amp for Pin1 & Pin4; 0.25 Amp for Other contacts.
 - Voltage Rating: 30V
 - Insulation Resistance: 100MΩ Min
 - Contact Resistance: 30mΩ Max for Pin1 & Pin4; 50mΩ Max for Other contacts.
 - Dielectric Withstanding Voltage: 100V AC (RMS)
 - Temperature Range: -20°C to +85°C
 - Mechanical Characteristics: Insertion Force: 35 Newtons maximum Extraction Force: 10 Newtons minimum
- P/N NOTE:
USB-A1SXXXM-X L9 X-W

Shell plate spec:
T=Tin, N=Nickel;
G=Gold;M=Gold and Nickel

Contact plate spec:
0: Fu" 1: 3u" 2: 6u"
3: 15u" 4: 30u" 5: 5u"
6: 10u" 7: 50u"

Product sequence: 01, 02, 03,

NO.	VARIETY	MATERIAL	QTY	REMARK
4	Cover	SPCC	1	See P/N Note
3	Front Shell	SPCC	1	See P/N Note
2	5P Semi-manufactured Goods	COPPER ALLOY T=0.25mm.	5	Gold Plated on contact area, and Tin Plated on Solder tail.
1	4P Semi-manufactured Goods	COPPER ALLOY T=0.25mm.	4	Gold Plated on contact area, and Tin Plated on Solder tail.

CZT DONGGUAN ZHENGDE (YIHUA) CONNECTOR CO., LTD

X: ±0.38	X': ±4'	UNIT:	mm	DR:	Jack	TITLE:	USB3.0 Standard-A Plug Solder
X ±0.25	X' ±2'	3RD:	⊕	DE:	River.lee	(Assembly Drawing)	0D:5.0
.XX±0.20	.XX'	SCALE:	3:1	CHKD:		SHEET:	1/1
.XXX±0.10	.XXX'	REV:	A-6	APPD:		P/N:	SEE TABLE
CUSTOMER DRAWING						D/N:	1004-0162
						M/N:	